

DIN 921

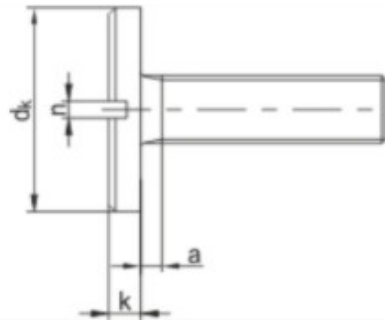

Wymiar	M 3	M 4	M 5	M 6	M 8	M 10
$a_{max.}$	1	1.4	1.6	2	2.5	3
d_k	8	12	16	20	25	30
k	1.8	2.4	2.7	3.1	3.8	4.6
n	0.8	1	1.2	1.6	2	2.5
$t_{max.}$	1.15	1.5	1.6	1.9	2.4	2.8

