

DIN 94
ISO 1234

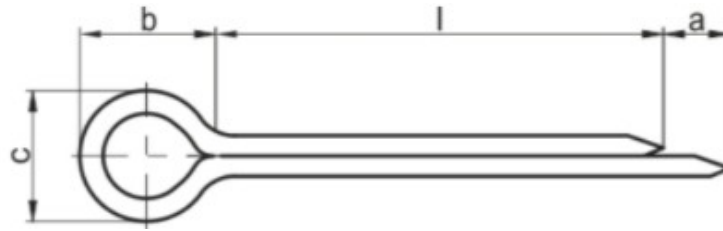

Wymiar	1	1.2	1.6	2	2.5	3.2	4
a_{\min}	0.8	1.25	1.25	1.25	1.25	1.6	2
b	3	3	3.2	4	5	6.4	8
c_{\max}	1.8	2	2.8	3.6	4.6	5.8	7.4
Pin hole \emptyset	1	1.2	1.6	2	2.5	3.2	4
For screw \emptyset	3.5-4.5	4.5-5.5	5.5-7	7-9	9-11	11-14	14-20
For clevis pin \emptyset	3-4	4-5	5-6	6-8	8-9	9-12	12-17

Wymiar	5	5.5*	6.3	8	10	13	16
a_{\min}	2	2	2	2	3.2	3.2	3.2
b	10	12.6	12.6	16	20	26	32
c_{\max}	9.2	11	11.8	15	19	24.8	30.8
Pin hole \emptyset	5	5.5	6.3	8	10	13	16
For screw \emptyset	20-27	21-27	27-39	39-56	56-80	80-120	120-170
For clevis pin \emptyset	17-23	18-23	23-29	29-44	44-69	69-110	110-160

